



Meaningful Innovation.

WEEE Number: 80133970

INSTRUCTION MANUAL

SOLAR LED FLOOD LIGHT



IP65
RATING

INTRODUCTION

Thank you for selecting and buying V-TAC product. V-TAC will serve you the best. Please read these instructions carefully before starting the installation and keep this manual handy for future reference. If you have any another query, please contact our dealer or local vendor from whom you have purchased the product. They are trained and ready to serve you at the best.



This marking indicates that this product should not be disposed of with other household wastes.



MULTI-LANGUAGE MANUAL QR CODE

Please scan the QR code to access the manual in multiple languages.

TECHNICAL DATA

MODEL	VT-411 CCT	VT-432
SKU	23756	10310, 10311,
LUMENS	1500 LM	4800 LM
EQUIVALENT WATT	100 W	300 W
LEDs	SMD 2835x88pcs	SMD 2835x90 pcs
BATTERY PACK	Li-ion Battery, 18650 3.7V, 3600mAh, 13.32Wh	LiFePO4 Battery, 32700, 6.4v, 6000mAh, 38.4Wh
MONO SOLAR PANEL	4.5W, 6V	12.5W,10V
DIGITAL PIR SENSOR	120°/6 Meters	120°/8 Meters
LIGHTING AREA	60-80m ²	100-150m ²
LAMP SIZE	152.7x146.8x31.2mm	199.7x189x189.9x49mm
SOLAR PANEL SIZE	202.1x220.9x24mm	354x254.2x38.3mm
INSTALLED HEIGHT	2~4 Meters	2~5 Meters
INSTALLATION DISTANCE	6-8 Meters	10-14 Meters
WARRANTY	2 Years Warranty(Battery 1 Year)	3 Years Warranty
BEAM ANGLE	120°x60°, Maximum Lighting design, Bigger Lighting Area	
WORKING MODES	Auto Sensor Mode Keep Lighting Mode (Can DIY Brightness and lighting time by remote)	
CHARGING TIME	5-6Hours Strong sunshine to fully charge	
LIGHTING TIME	Up to 60Hours according to different working mode	
LAMP BRACKET	360° Adjustable	
SOLAR PANEL BRACKET	270° Adjustable	
CONNECTION CABLE	5 Meters Long	
HOUSING MATERIAL	ABS+PC+ALUMINIUM, Anti-UV, V0 Fireproof	
PACKING	1 Lamp, 1 Solar Panel, 1 Remote Control, 4 Set Screws,1User Manual	

WARNING

1. This is a solar powered lamp, please install the solar panel in a location where can get enough sunshine.
2. Please note the lighting time depends on sunshine duration & working mode.
3. The On/Off button on the lamp is power-off switch, helpful to save power consumption. Also the lamp can still get solar charge at day time when the lamp is turned off.
4. Built-in intelligent IC is with over-charge and over-discharge protection, safe & durable.
5. Non-professionals please do not disassemble the lamp.
6. Please do not dispose the battery with household garbage to avoid explosion.

INSTALLATION

Prepare the lamp, accessories and tools well, confirm the installation location and wire length.

1. Drill 2 holes of $\varnothing 8$ mm with a depth of 60mm on the wall, fix the lamp on the wall with expansion plugs and screws.
2. Drill 2 holes of $\varnothing 8$ mm with a depth of 60mm on the wall, fix the solar panel on the wall with expansion plugs and screws.
3. Connect the wire of the solar panel to the lamp and screw it tightly.
4. Press the button on the lamp to activate the remote control, then use remote control to set desired working mode and CCT.

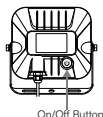
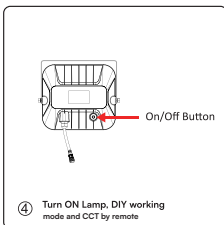
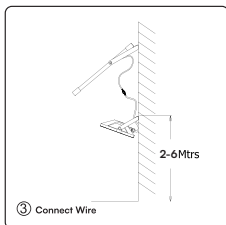
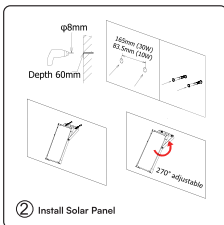
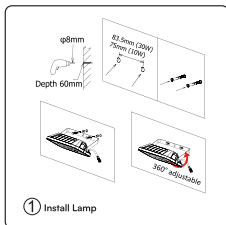

Firstly, please press the button on the lamp, lamp turns on and automatically enter Keep Lighting Mode (Default Mode). Press the button again, lamp turns off.

After the lamp is turned on, then please use remote control to select demanded work mode and CCT.

Keep Lighting Mode (Default Mode)



Lamp automatically lights up at night and keeps 60% for 3 hours, after which lamp turns to Sensor Mode.

In this mode, you can select the desired lighting time and brightness by the remote control.

For example:

Press + + , the lamp will work as below:

Lamp automatically lights up at night and keeps 40% brightness for 5 hours, after which lamp turns to Sensor Mode.

Sensor Mode



Lamp automatically lights up at night and turns to full brightness when motion is detected in the range, then turns to 5% brightness in 30 seconds of no motion.

OPERATIONS OF DIY WORK MODE AND CCT BY REMOTE CONTROL

- * Please remove the insulating film of the remote control before use.
- * Remote control distance: 6 meters.
- * Each time you press a button on the remote, the lamp flashes once.
- * ON/OFF switch on the remote control has memory function.
- * Lighting brightness and time can only be adjusted in Keep Lighting Mode.

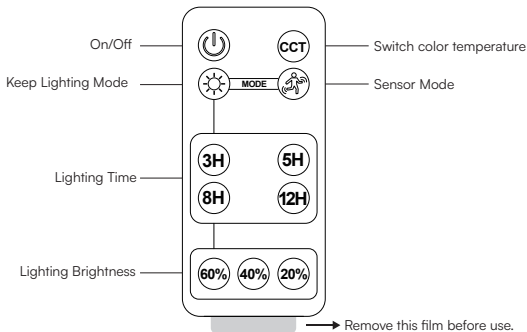

OPERATION OF INDICATOR LIGHT

This lamp has a red indicator light, which shows the charging state of the lamp.

Indicator Light Status During the Day	Working Status of Solar Lamp
Always on	Lamp is fully charge.
Flashes every 3 seconds	Solar panel is charging normally.
Off	The ambient sunlight is not strong enough to get the solar panel charged.

Indicator Light Status At Night	Working Status of Solar Lamp
Off	Lamp discharges and works well.
Flashes every second	Lamp discharges and works well, but battery power is less then 30%.

WIDE APPLICATIONS

Widely used for construction site, gate, courtyard, corner, garden, industrial area, warehouse, garage, parking lot, roof, factory, pathway, farm, pavilion, countryside, pergola, bus station etc.
